

LOT 2, ERIE AIR PARK SUBDIVISION REPLAT A

P.U.D. ZONING MAP

LOCATED IN THE SW1/4 OF SEC. 31, T1N, R68W OF THE 6TH P.M.
 TOWN OF ERIE, COUNTY OF WELD, STATE OF COLORADO
 PUD-000712-2015

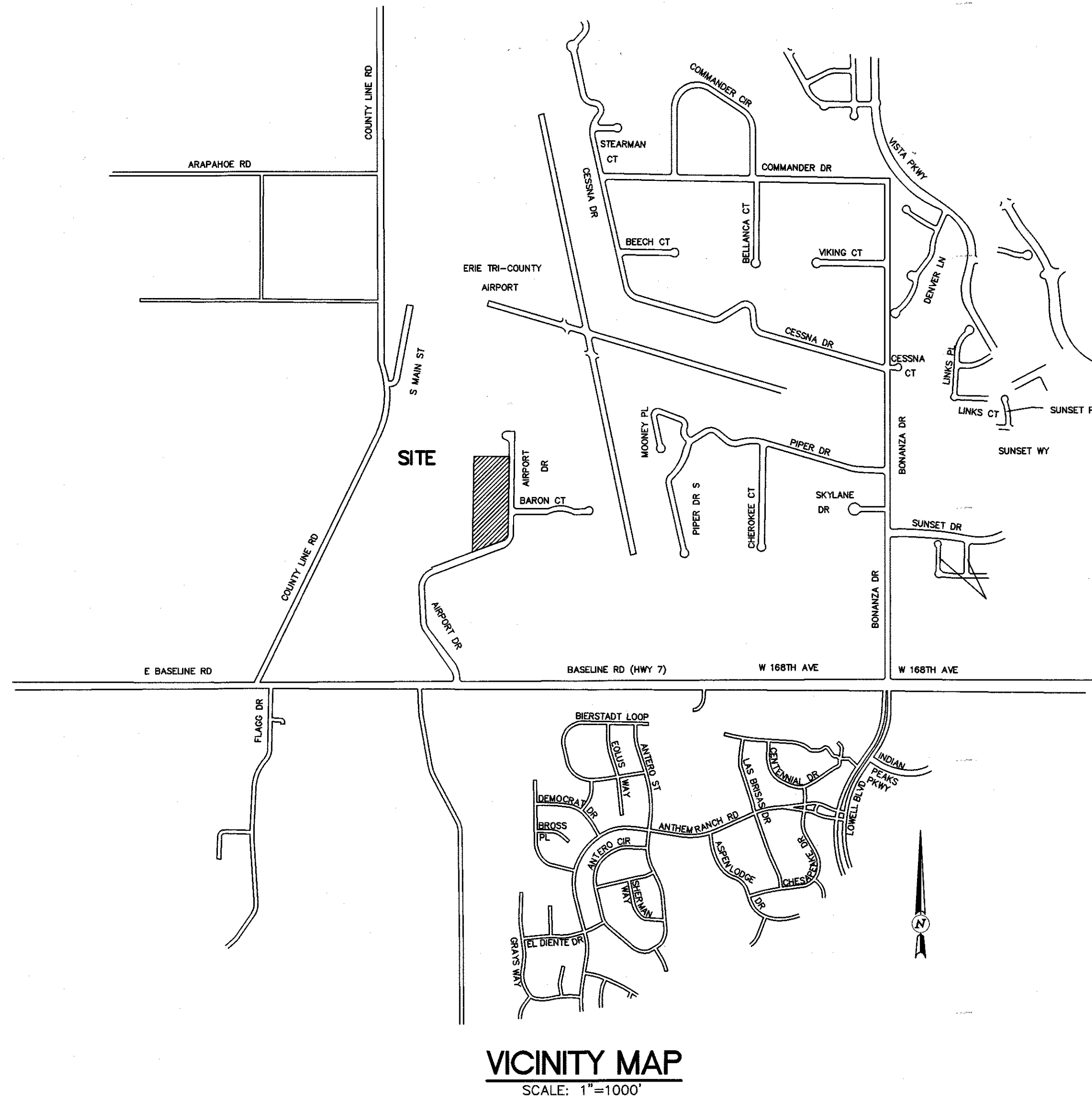

LEGAL DESCRIPTION:

LOT 2, ERIE AIR PARK SUBDIVISION REPLAT A, AS PER PLAT RECORDED SEPTEMBER 4, 1992 IN BOOK 1350 AT RECEPTION NO. 2302520, COUNTY OF WELD, STATE OF COLORADO.

A.K.A. 3000 AIRPORT DRIVE

SURVEYOR'S CERTIFICATE

I, A. JOHN BURI, A DULY REGISTERED PROFESSIONAL LAND SURVEYOR IN THE STATE OF COLORADO, DO HEREBY CERTIFY THAT THIS PUD ZONING MAP TRULY AND CORRECTLY REPRESENTS THE ABOVE DESCRIBED LEGAL DESCRIPTIONS FOR EACH PUD OVERLAY ZONE DISTRICT.

I ATTEST THE ABOVE ON THIS 19TH DAY OF MAY, 2016.

A. JOHN BURI,
 FOR AND ON BEHALF OF
 SCOTT, COX & ASSOCIATES, INC.

COLORADO REGISTERED PROFESSIONAL LAND SURVEYOR 24302

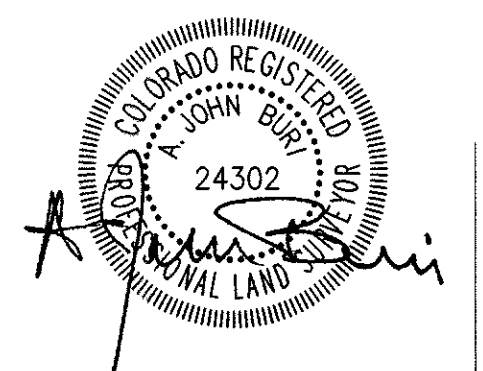

NOTES

- BEARINGS ARE BASED ON THE EAST LINE OF LOT 2, ERIE AIRPARK SUBDIVISION, REPLAT A, BETWEEN THE FOUND MONUMENTS AS SHOWN HEREON.
- THIS PUD ZONING MAP MODIFIES THE USES SET FORTH IN THE TOWN OF ERIE UNIFIED DEVELOPMENT CODE (UDC) AS PROVIDED FOR IN SECTION 10.3.1.
- THE TABLE OF PERMITTED USES IN THE UDC FOR THE UNDERLYING ZONE DISTRICT(S) SHALL GOVERN THE PROPERTY UNLESS OTHERWISE ALTERED OR MODIFIED BY THIS PUD.
- IN THE EVENT THAT THERE IS ANY DISCREPANCY BETWEEN THE UDC AND THIS PUD, THE PUD SHALL CONTROL. ANY PROVISIONS THAT ARE NOT SPECIFICALLY ADDRESSED IN THIS PUD ZONING MAP SHALL COMPLY WITH THE UDC.

PERMITTED USES BY RIGHT

THE FOLLOWING USES SHALL BE PERMITTED BY RIGHT IN THE ERIE AIRPARK REPLAT A, LOT 2 PUD AREA AS DEFINED IN THE TOWN OF ERIE UNIFIED DEVELOPMENT CODE:
 AVIATION MUSEUM; REPAIR SHOP; CONTRACTOR'S SHOP, INTERIOR ONLY; INDUSTRIAL, LIGHT; LIGHT EQUIPMENT SALES, SERVICE AND RENTAL; LIGHT MANUFACTURING, GENERAL.

SPECIAL REVIEW USE

THE FOLLOWING USES, AS DEFINED IN THE TOWN OF ERIE UNIFIED DEVELOPMENT CODE, SHALL BE REVIEWED PURSUANT TO THE SPECIAL REVIEW USE PROCESS AND APPROVAL CRITERIA:
 MUSEUM; COMMERCIAL AMUSEMENT, INDOOR; CONTRACTOR'S SHOP WITH EXTERIOR STORAGE OR STORAGE YARD.

PLANNING COMMISSION CERTIFICATE

THIS PUD ZONING MAP WAS REVIEWED BY THE PLANNING COMMISSION ON THE 18th DAY OF NOVEMBER, 2015.

CHAIRPERSON: *[Signature]* DATE: 1 June 2016

BOARD OF TRUSTEES APPROVAL CERTIFICATE

THIS PUD ZONING MAP IS TO BE KNOWN AS LOT 2, ERIE AIRPARK SUBDIVISION REPLAT A, PUD ZONING MAP* AND IS APPROVED AND ACCEPTED BY ORDINANCE NO. 02-2016 PASSED AND ADOPTED AT THE REGULAR (SPECIAL) MEETING OF THE BOARD OF TRUSTEES OF ERIE, COLORADO, HELD ON JANUARY 12, 2016.

MAYOR

ATTEST

[Signature]
 TOWN CLERK

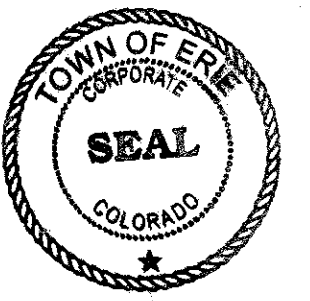

CLERK & RECORDER CERTIFICATE

STATE OF COLORADO)
) SS.
 COUNTY OF WELD)

I HEREBY CERTIFY THAT THIS PUD ZONING MAP WAS FILED IN MY OFFICE ON THIS DAY OF _____, 201____ A.D. AND WAS RECORDED AT RECEPTION NUMBER _____

WELD COUNTY CLERK AND RECORDER

PUD ZONING MAP
3000 AIRPORT DRIVE
ERIE, COLORADO



Designed by	DPA	Date	11/06/15	Scale	AS SHOWN	Drawing no.	13156B-4	Sheet	1
Drawn by	JAS	Revision		Description		Date		Project no.	13156B
Checked by	DPA								